



MODEL:AT8502 OWNER'S MANUAL



PLEASE READ BEFORE USE

1 Getting Started

Welcome

Thank you for purchasing a Uniden phone.

NOTE : Illustrations in this manual are used for explanation purposes. Some illustrations in this manual may differ from the actual unit .

Key Features

- FSK/DTMF caller ID
- Backlit display (need to insert batteries)
- 2-Line operation and music on hold
- 3 party conference (with 2 external lines)
- Storage of incoming and outgoing numbers:

	8 Digits	12 Digits	16 Digits
Outgoing	99	99	87
Incoming	99	29	23

- 12 two touch memories, 7 one touch memories (16-digit number)
- 12 Ringtones Selectable
- Ringer, Earpiece & Speakerphone Volume Control -3 levels
- LCD contrast adjustment-4 levels
- 1 outgoing code; 5 local codes
- Tone/pulse dialing
- Pre-dial and redial function
- New call indicator, total number of calls indicator
- VIP function settings
- Flash time selectable (1000ms / 600ms / 300ms / 180ms / 120 ms / 90 ms)
- 3 alarm clock

Accessories (included)

1. Base unit
2. Handset
3. Telephone line cord
4. Handset cord
5. User manual
6. Stand

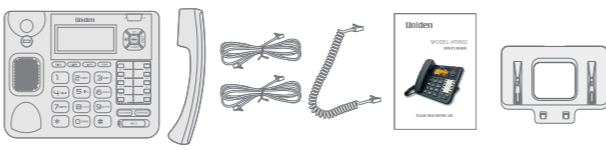

- 1
- 2
- 3
- 4
- 5
- 6

NOTE: If you find any of the parts missing, please contact your local shop where you buy this product at once.

Battery Installation

Install 3 X AAA batteries (Batteries not included)

Wall Mounting

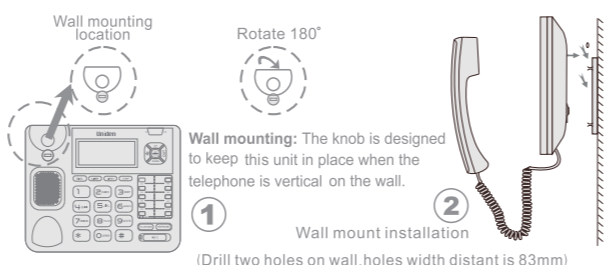

LCD Display Layout



- | | |
|-------------------------------|---------------------------|
| 1 18.08.08:08 | Date,time |
| 2 IN | Incoming call |
| 3 OUT | Outgoing call |
| 4 NEW REP MAIL | Lock,new call,repeat,mail |
| 5 0000000000000000 | Phone number display |
| 6 SUN MON TUE WED THU FRI SAT | Week display |

2 Setup and operation

If it is used as single line, please use line 1 and plug the telephone line into the L1 jack. Please insert the battery to enable the screen backlight function.

In the on-hook state, press the " SET/HOLD " key to enter the setting menu and display [2345678], press the " DEL/R " key to exit the setting during the setting process, and press " SET/HOLD " to return to the previous menu. Without any operation for 13 seconds, it will automatically exit the setting and return to the standby screen.

Time/Date

" SET/HOLD " → Display show [2345678] → Press " 1 " → Enter the number → " UP " / " DOWN " → " SET/HOLD " (Note that the clock is a 24-hour clock)

2 Setup and operation

Local code

" SET/HOLD " → Display show [2345678] → Press " 2 " → display [Code -----] → enter the number or press " * " to cancel the local code.

Outgoing code

" SET/HOLD " → Display show [2345678] → Press " 3 " → display → [Code -----] the number or press " * " to cancel the outgoing code.

Note :

- 1:When the outgoing code is set, the outgoing code will be automatically added while.
- 2: The outgoing code setting is convenient to use on the internal switch.

Flash time

The default value is 600ms. There are 1000ms / 600ms / 300ms / 180ms / 120 ms / 90 ms to choose from. " SET/HOLD " → Display show [2345678] → Press " 4 " → display [FLASH 600] → " UP /DOWN " → " SET/HOLD "

LCD Contrast

Default value is 3.Total of 4 levels can be selected. " SET/HOLD " → Display show [2345678] → Press " 5 " → displays " LCD 3- " → " UP /DOWN " → " SET/HOLD "

Alarm

" SET/HOLD " → Display show [2345678] → Press " 6 " → display [AL 123] First alarm setting: Press " 1 " → [AL 1 OFF] (means the alarm is off) → press " * " to switch on-off → display [AL 1 12:00] → directly enter the time → " SET/HOLD ". The second and third groups of alarm clock setting are the same. **Note:** The alarm setting is a 24-hour system. The alarm 1 is powered by the telephone line 1. When the set time is 30 seconds, lift the handset or press the number key to terminate.)

Ringtone

" SET/HOLD " → Display show [2345678] → Press " 7 " → display [09 L1-L2] Press " 1 " (or 2) → display [09 01] → corresponding ringtone will sound number → " UP " / " DOWN " → press " DEL /R " key to exit.

Note: Two lines can be set with different ringtones to distinguish incoming call lines. There are 12 ringtones for line 1 and line 2.

STONE/PULSE

" SET/HOLD " → Display show [2345678] → Press " 8 " → display → " UP /DOWN " → [STONE] / [PULSE] → " SET/HOLD ".

Note: The factory preset is TONE dialing system, this item does not need to be set in general areas, and set according to telecommunication requirements for special areas.

One Touch and Two Touch memory storage and dialing

One-Touch memory storage: phone number + " FL/STORE " + Mi (i=1-7)
Two Touch memory storage: Phone number + " FL/STORE " + number keys (0-9; *; #)
Note: If an outgoing code is set, it is not necessary to add the outgoing code when storing the number. During pre-dial and number storage, press " DEL/R " to delete digit by digit.
One-touch dialing: press " M1-M7 " when off-hook

Two-Touch dialing: Press " MEM " when off-hook → LCD displays "RECALL" prompt → number keys (0-9; *; #) → LCD displays the stored number (if LCD displays [-----] means that there is no number stored in the storage location of the serial number.)

View outgoing history

In off-hook/on-hook state → " OUT " → " UP /DOWN " If there is no outgoing call information, press this button to display [-----]

3 Two Lines Operations

Answer the phone

When an outside line comes in, the corresponding L1 and L2 incoming bell lights will flash, and the answer can be automatically answered by removing the handle or pressing the " hands-free " button. If the bell comes at the same time, directly press the " LINE1 " key to connect to line 1 and enter the hands-free state; directly press the " LINE2 " key to connect to line 2 and enter the hands-free state; if directly picking up the handle or pressing hands-free to answer, Automatic priority to connect to line 1.

Hang up the phone

When line 1 is in the hands-free mode, press the " LINE1 " key or the " hands-free " key to hang up line 1; line 2 will remain in the original state (hold or hang up). vice versa. When the handle hangs up, it automatically hangs up the external line currently in use, and the other line remains in the original state (reserved or hang up).

Speakerphone

Press the " Speakerphone " key to automatically select line 1 and enter the hands-free state; or directly press the " LINE2 " key to connect to line 2 and enter the hands-free state; in the hands-free call state, the handset can be turned off and the handset can be turned off. Talk with the handle. No matter which line or two lines are in the call state of the handset, press the " Speakerphone " button, and the handset will enter hands-free state conversation after hanging up the handset.

Music on Hold

When line 1 is off-hook, if you press the " SET/HOLD " button, line 1 will automatically be retained and play music, and the display " 1L " flashes. If you press the " LINE1 " key, the line 1 reservation will be cancelled and the call will be resumed. vice versa.

Switch between Line 1 and 2

Line 1 is in off-hook talking state, If you directly press the " LINE2 " key to connect to line 2, line 1 will hang up, and vice versa: If you press the " SET/HOLD " button and then the " LINE2 " button, line 1 will automatically be retained and play music, and the display will flash with " 1L " . Line 2 is connected and vice versa.

Three-party conference

First connect to line 1 and hold the call, then connect to line 2, and then press the CONF key to enter the three-way conversation state. In the three-way conversation state, if Xi ends one of the calls, press " LINE1 " to hang up line 2. Line keeps the call; press " LINE2 " to hang up line 1 and line 2 to keep the call.

4 Troubleshooting

No dial tone

- Check all cabling to make sure that all connections are secure and not damaged .
- Ensure the telephone line cord is securely connected to the modular jack .
- Connect another phone to the same modular jack .If it does not work , the problem might be your wiring or local service .
- Use another telephone line .

Incoming voice too low or none at all

- Check and adjust volume control setting .

No Caller ID

- Make sure you have subscribed to the Caller ID service from your local telephone Company

5 Safety Instructions

Take special care to follow the safety suggestions listed below . Please do not use telephone during thunderstorm.

Installations Environment

1. Avoid putting the phone near heating appliances and devices that generate electrical noise (for example, motors or fluorescent lamps).
2. Do NOT expose to direct sunlight or moisture.
3. Do not install the telephone during thunderstorm.
4. Clean the phone with a soft cloth.
5. Never use a strong cleaning agent or abrasive powder because this will damage this unit.
6. Avoid dropping the handset ,as well as other rough treatment to the phone.

Placement

1. Do not place heavy objects on top of this unit .
2. Care should be taken so that objects do not fall onto, and liquid into , the unit. Do not subject this unit to excessive smoke ,dust, mechanical vibration or shock .

WARNING : To prevent fire or shock hazard , do not expose this product to rain or any type of moisture.

Distributor:
US Telecom Limited
info@ustel.com.hk
www.ustel.com.hk

6 WARRANTY CARD

18.COM Electronics Pte Ltd.

WARRANTY CARD

Name: _____

Contact No. Tel: _____

Model: _____

Date Of Purchase: _____

Serial No.: _____

Dealer's Stamp: _____

Service Centre:
Monday- Friday Opening Hours
9:30am - 12:30pm, 2:00pm - 5:00pm
Tel: 6278 8274

CUSTOMER'S COPY : DO NOT MAIL THIS

1. This warranty starts on the date of purchase and expires in 1 year. Customer must bring along this warranty card and original invoice or receipt together with the complete product for any repair services.
2. Any warranty application with no invoice and/or warranty card are regarded as invalid warranty. Customer must pay for repair charges.
3. This warranty is invalid if the product has been modified, altered and / or repaired by persons other than technician of our company or mishandled by customer.
4. This warranty is applicable to Singapore only.
5. This warranty does not cover damages caused by natural disasters such as flooding and lightning etc.
6. Customers are requested to collect repaired unit within two months from date of submission. Units not collected after 6 months will be disposed off by the company.

18.COM Electronics Pte Ltd, 159 Sin Ming Road, Amtech Building, #04-01, Singapore 57625